

1st edition



## MODULAR THEATRE CATALOGUE



[www.sisurgical.co.in](http://www.sisurgical.co.in)



## ABOUT US

S.I. Surgical Pvt. Ltd. is a professional manufacture for Hospital Furniture,OT table,OT light,which specialized in R & Dproduction sales,Electro Surgical Equipment,Surgical Instruments & Laparoscopy Instruments that total is more than 4500 product series.

The factory was established since 2005 registered capitalized 15 million dollar.We are original developed our own range of product by adopting international advance information technology,our production process was strictly complied with ISO 9001:2015 international quality management system.

S.I. group of company has three registered brand which are S.I. Surgical Pvt. Ltd.,Pearl Endoscope and Renomed India.Through several years of unremitting efforts,till now we have two large modern workshop & one is completed 25000 sq.ft. corporate office & showroom. More than 100 excellent employee team, called as a perfect system.S.I. surgical is always developing continuously and producing & developing high value and high quality product that can needs of global medical equipment market.Our products are not only sold all over India also export Europe,USA ,East Africa, Middle East more than 22 countries & areas.We also setup our own trading company.

Now S.I. surgical also started complete set up of modular theatre,modular ICU & AHU system.

S.I. Surgical wined ISO 9001:2015 CE and FDA(process)certified Company.

## MODULAR OPERATION THEATRE

The construction is done with readymade prefab panels with speedy construction and high quality finishes and flexible to future expansions and maintenance without interrupting other functioning departments.

We offer turnkey engineering solutions for modular operating rooms which includes Site Survey, Design, Supply, Supervision, Installation, Testing & Commissioning, Operation & Maintenance of the system.





# STAINLESS STEEL PANELS



## WALL AND CEILING PANEL

www.alexers.com

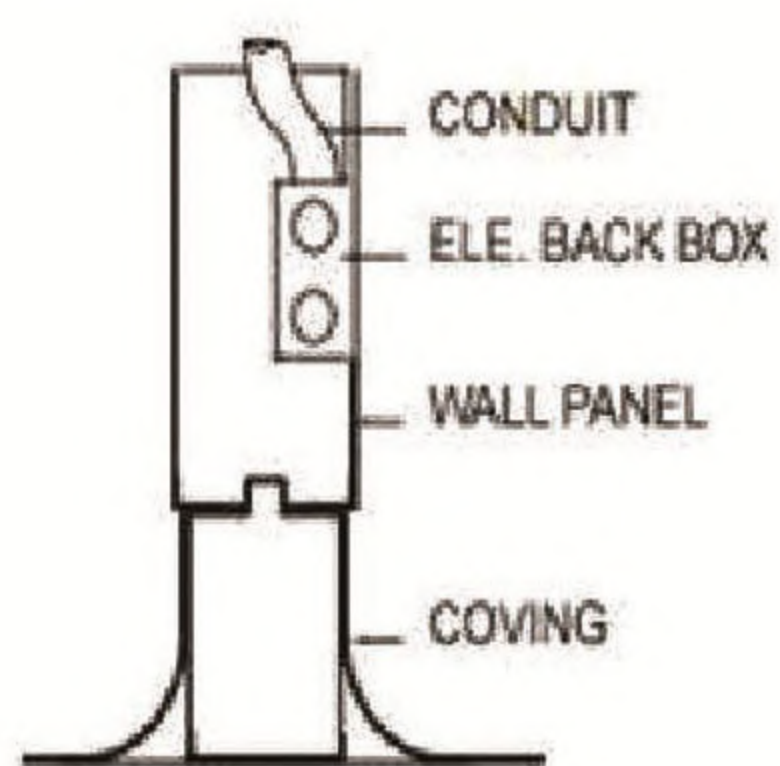

BASE DETAIL

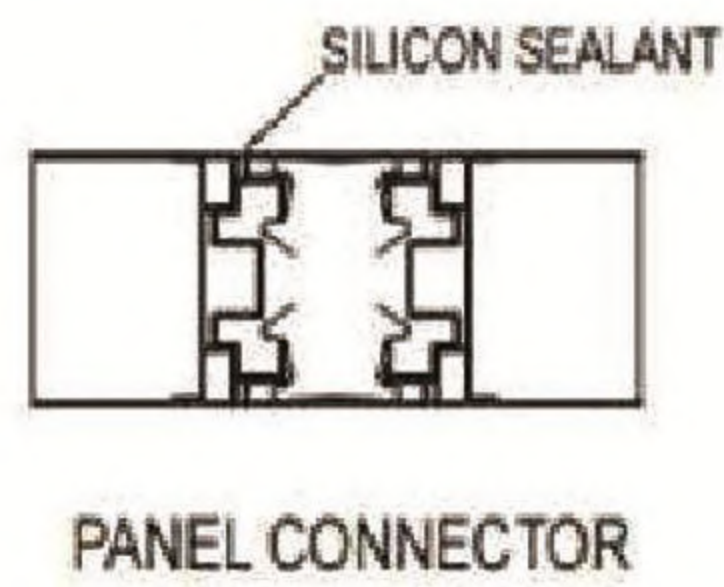

PANEL CONNECTOR

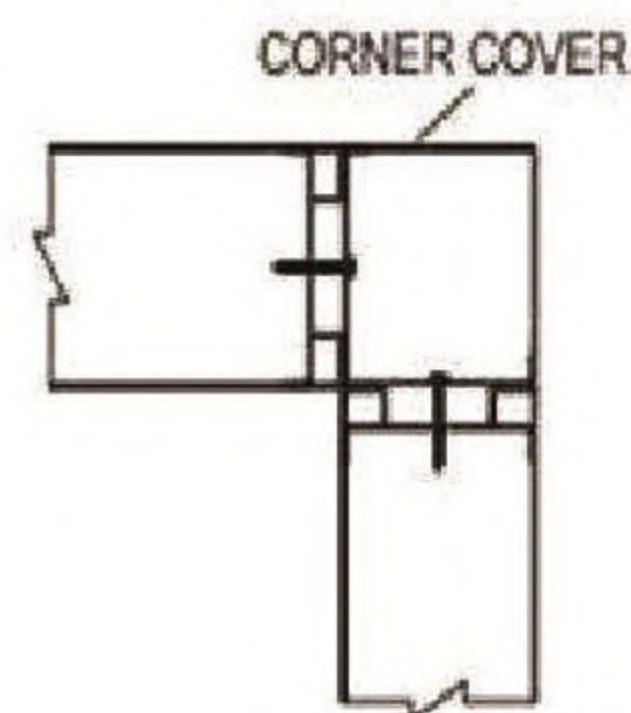

CORNER DETAIL

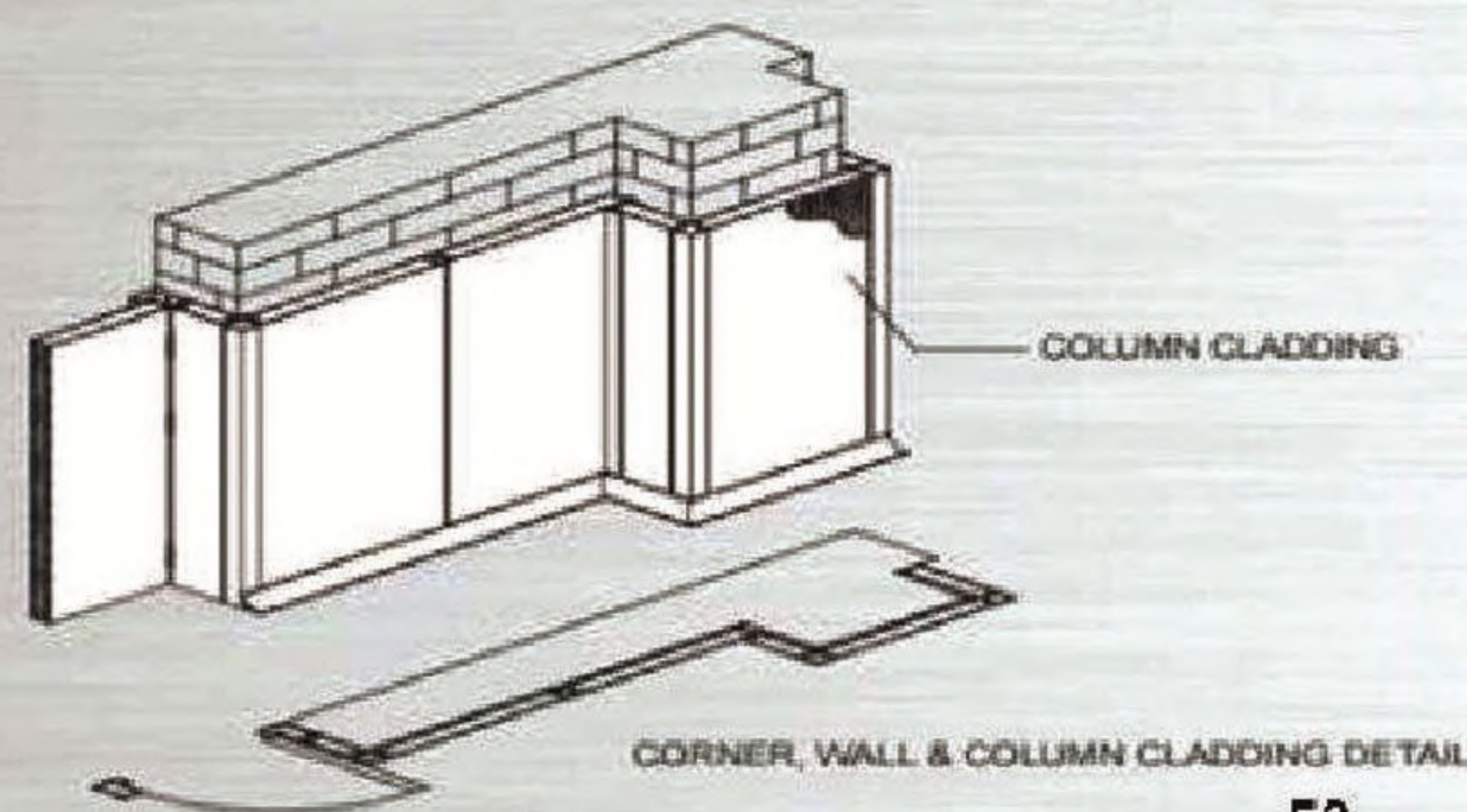

CORNER, WALL & COLUMN CLADDING DETAIL

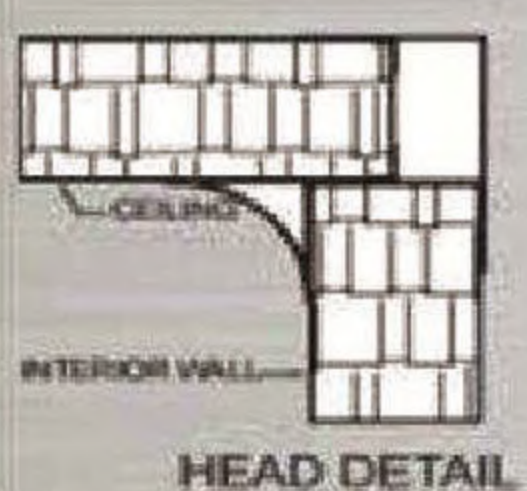

HEAD DETAIL

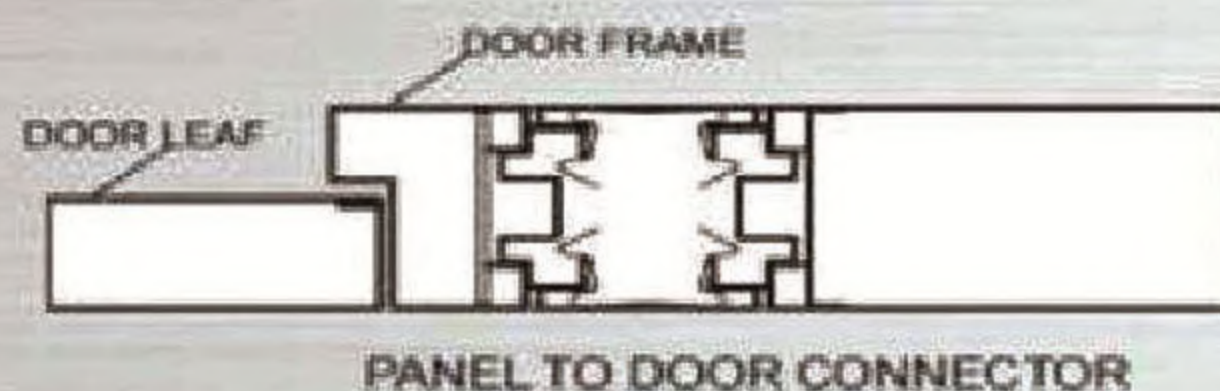

PANEL TO DOOR CONNECTOR

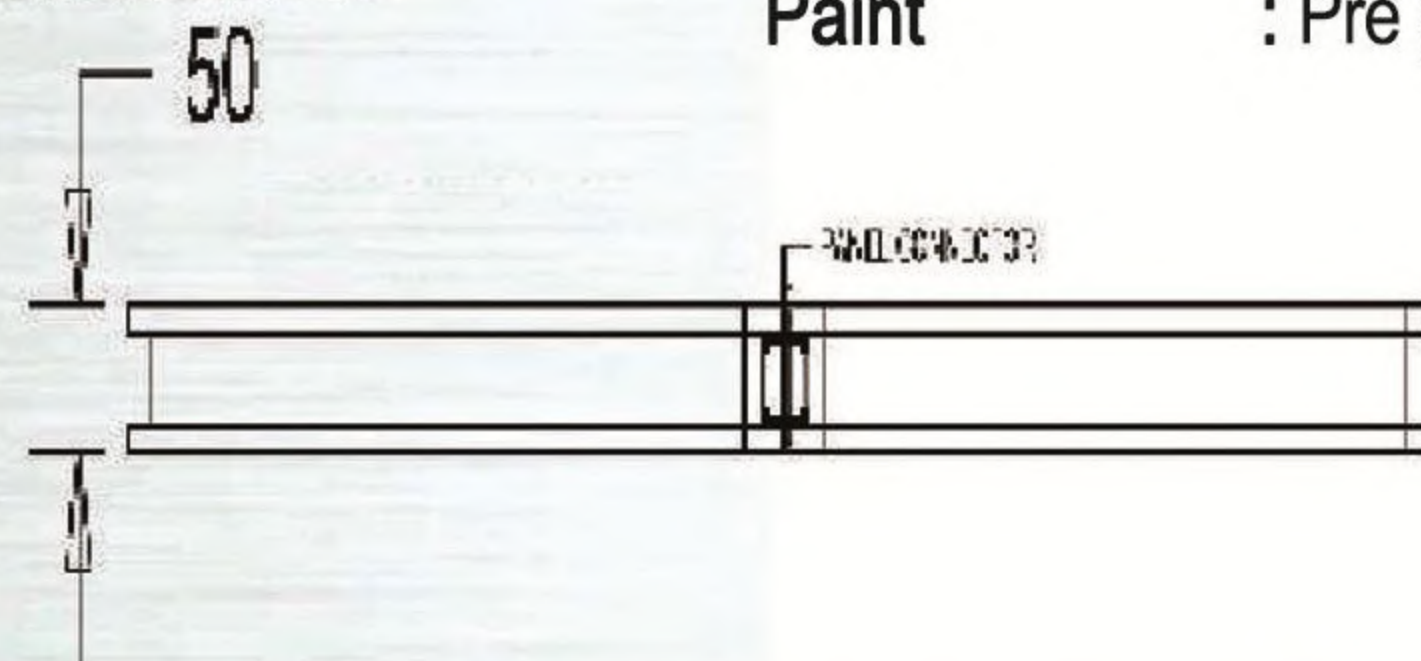

### Technical Specifications

- Thickness** : 30mm,50mm,60mm,80mm,100mm
- Material in Fill** : rigid polyurethane or honey comb
- Wall Material** : SS-304,PPGI Aluminum, HPL, GPSP
- Density** : 40 to 42Kg/m<sup>3</sup>
- Joint** : Male/Female connector
- Cut Outs** : As per requirement
- Paint** : Pre paint/anti-bacterial



## PPGI PANEL



M&L for PPGI wall panelling in OT/ICU with following Specification:- Standard wall partitions with composite construction of two skins of PPGI/PPGI Over an GI/AL frame work with a sealed & insulated interior. Standard panels shall have an overall thickness of 50mm. The self supporting internal walls constructed with an interior GI / AL frame work. Partition partition connections are maintained with precision with AL / GI profiles that creates uniform seams. The partitions seams are sealed by silicone with perfectly flush finishing. PUF insulation material is sandwiched between skin layers & sealed from the exterior by the aluminium frame work.



# LAMINOR AIRFLOW

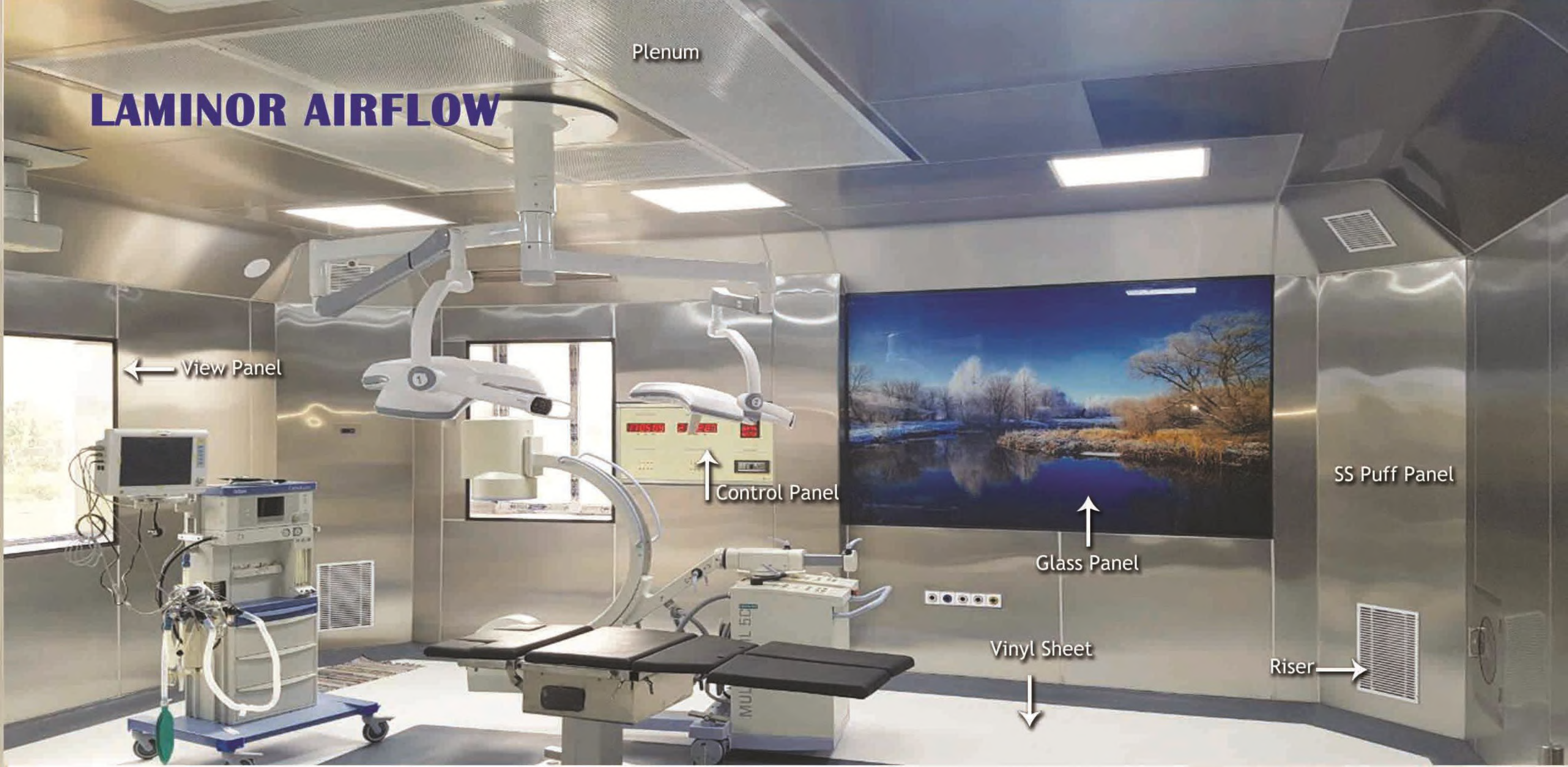

Specialised Air Distribution based on Total Pressure Displacement so as to ensure Uniform air quality & quantity along the complete LAF area. Minimum total air changes should be more than 30 per hour. It shall be terminal filter (HEPA filter shall be fitted across total filtration area i.e. 48 sq.ft), Ultra Clean ventilation system with unidirectional flow. It shall be draft-free, comfortable room climate and minimal, undistruptive noise level. It shall have filtration area 2 no's of atleast 1850mmX2440mm and capable of filter 6000cfm of air. It shall have minimal pathogen concentration < 10 c.fu./Cum.

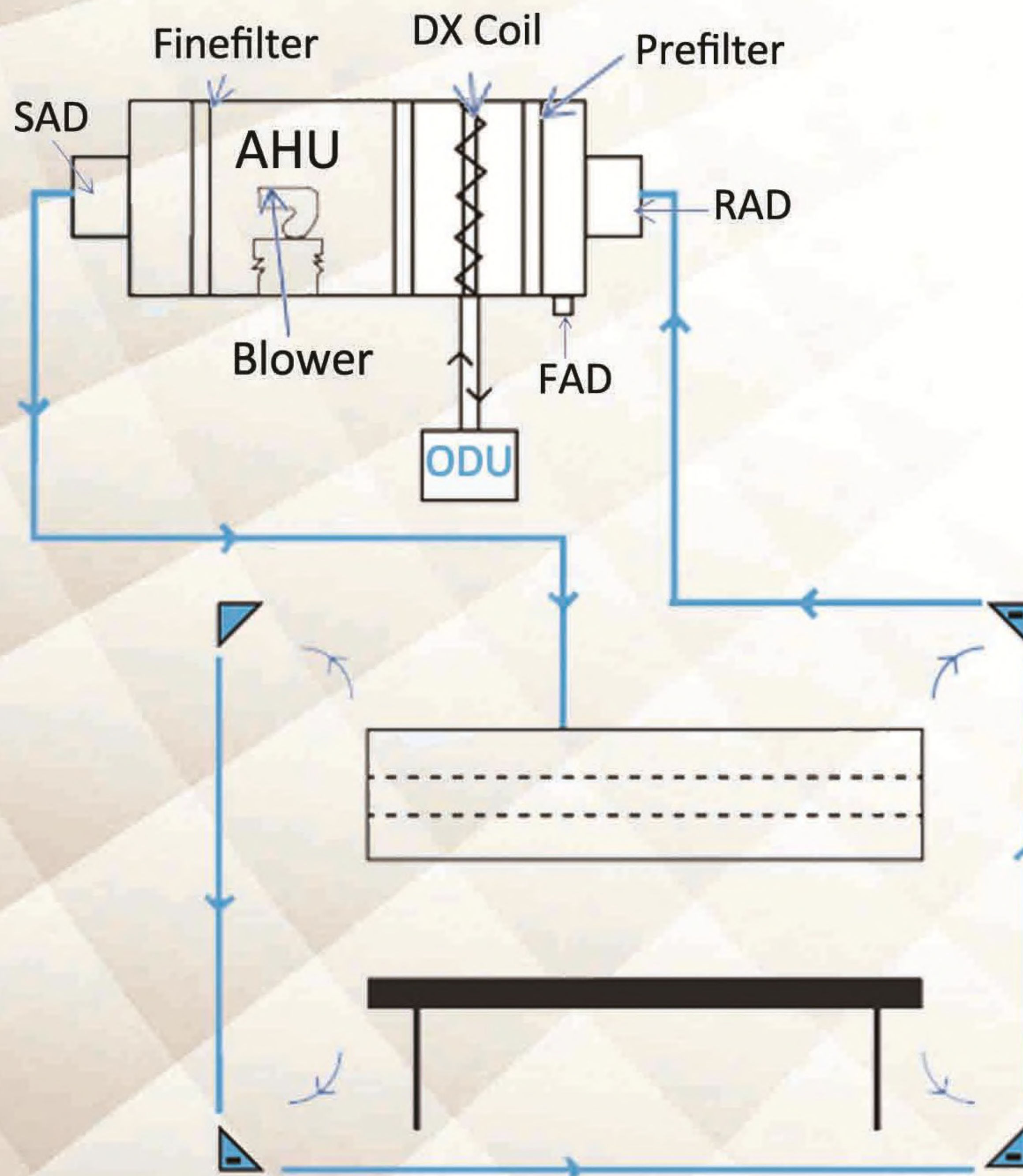

100% Supply = 75% of Return + 25% Fresh Air



## AIR HANDLING UNIT(AHU)



ZECO, India's most preferred air handling unit manufacturing company has been in existence from last two decades. With this experience and expertise we manufacture a wide range of air handling units in our automated manufacturing facility. Our Air Handling Units (AHU) are available up to 100,000 cfm capacity. Superior Features: - Rigid framework design has inherent strength and stability. The aluminium profiles are corrosion resistant with specially designed three way corners. The panels are pressure injected with CFC free polyurethane foam up to 40 Kg/cum densities. The entire framework is mounted on a galvanized steel channel base.

The condensate drain pan is fabricated out of corrosion resistant SS-304 stainless steel insulated on outside with close cell insulation. The units are compact in design to provide vibration-free, noiseless performance and are easily maintainable. Basic assembly consists of sections with imported centrifugal fan, cooling coil, and filters. Add-on optional modules such as thermal break with coved profiles, heating coil, face and pass damper, humidifiers and air mixing chambers are also available on specific demand. Units can be manufactured with direct drive plug fans as well.

## PLENUM



Filter housing and pressure chamber made out of high-end stainless steel 304 medical grade steel with matt polish sheet thickness 1.2mm specially designed to deliver uniform velocity across the entire HEPA plenum to maintain uniform laminarity of air -01 No.



## SURGEON CONTROL PANEL :



## SURGEON CONTROL PANEL (standard) :

- 1: Day time clock
- 2: Elapsed time clock
- 3: OT control
- 4: Temperature and Humidity controller
- 5: Hepa Pressure Guage

## SURGEON CONTROL PANEL ( Customized)

- 1: Day time clock
- 2: Elapsed time clock
- 3: OT control
- 4: Temperature and Humidity controller
- 5: Hepa Pressure Guage
- 6: Hands free phone
- 7: Medical Gas Alarms

## AHU CONTROL PANELS :

- 1: Control panel with have VFD
- 2: Main Failure Relay
- 3: Electrical distribution equipment and separate MCB's for all electrical HVAC equipment.

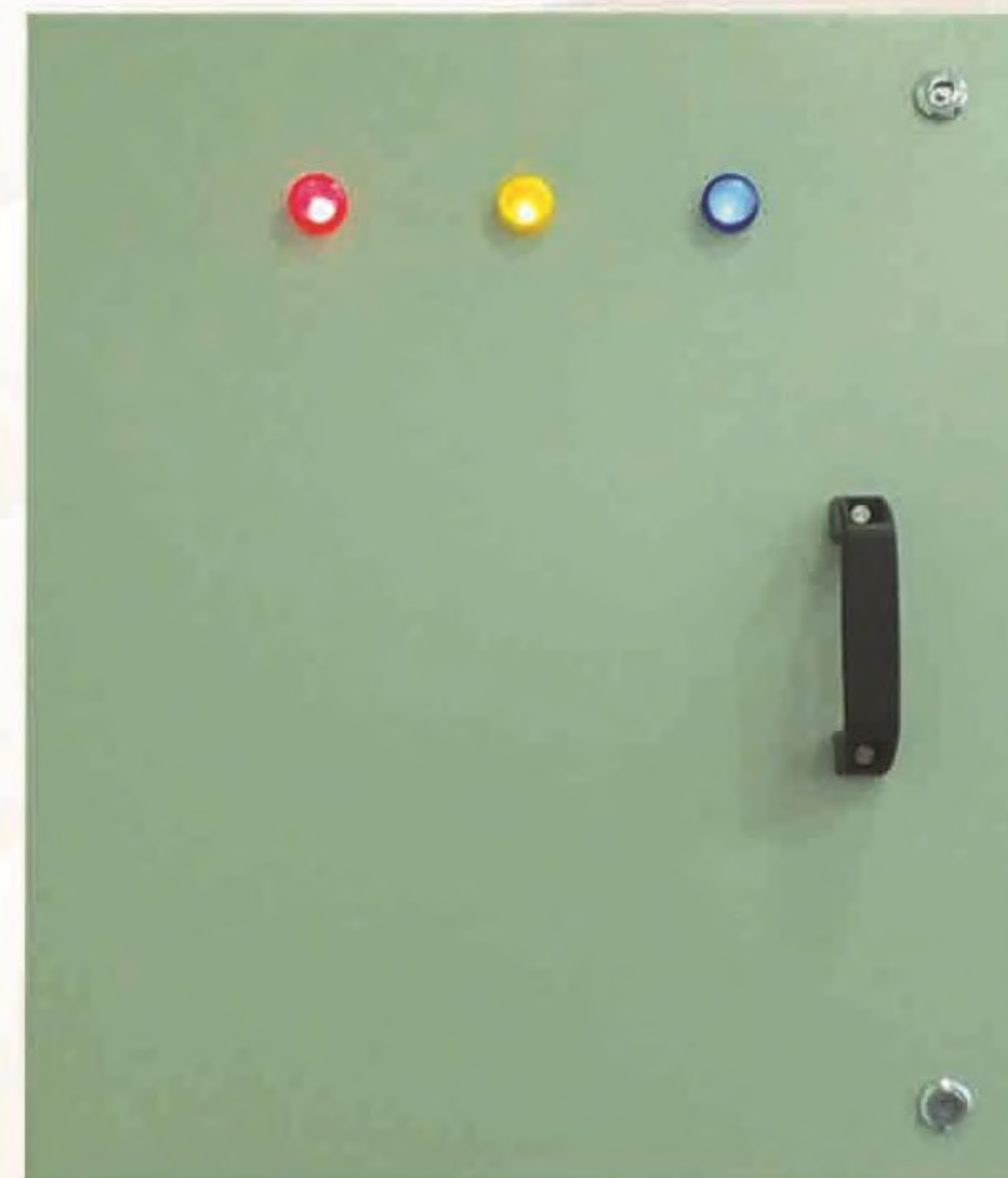

## DIFUMIGATION CONTROL PANEL :



## DEFUMIGATION CONTROL PANEL:

- 1: OR Temperature
- 2: Defumiagtion control system
- 3: AHU motor control to increase OR pressure after defumigation.



## PARTIALLY HERMETICALLY DOORS



Double Door



Single Leaf Door



Sliding Door



Double Leaf Door



# SARVATTAM DOORSETS AND FRAMES

Description	Sarvattam Doorsets and Frames
Construction	Door leaf from 0.8mm/1.0mm/1.2mm/1.6mm thick zinc coated galvanised steel. Zinc coating 80-120 g/m <sup>2</sup> . Lock formed profile with internal stiffeners, 4.0mm thick hinge reinforcing, hardware mounting plates and lock protection. Doorframe from 1.2mm/1.6mm/2.0mm thick galvanised steel with mitered and welded corners, frame straps, Hinge reinforcing plates, fixing plates and hardware mounting plates
Insulation	Door leaf filled with either mineral wool, honeycomb paper
Finish	Pure/Epoxy Polyester powder coating
Fixing	Fixing through frame by expansion bolt & Mortar straps.
Frame Assembly	Welded construction with frame spacers. Bolted frame construction Knock Down frame construction for wrap around frames.
Glazing	5.0mm thick glass on both side in door leaf/one glass in middle
Louver	Louver panels to door leaves.
Fire Resistant	Up to 3 hours fire resistance in accordance with BS 476 part 22, UL 10B & UL 10C dependent on construction.
Sizes	Up to 3 mtrs high and 3 mtrs wide subject to test limitations

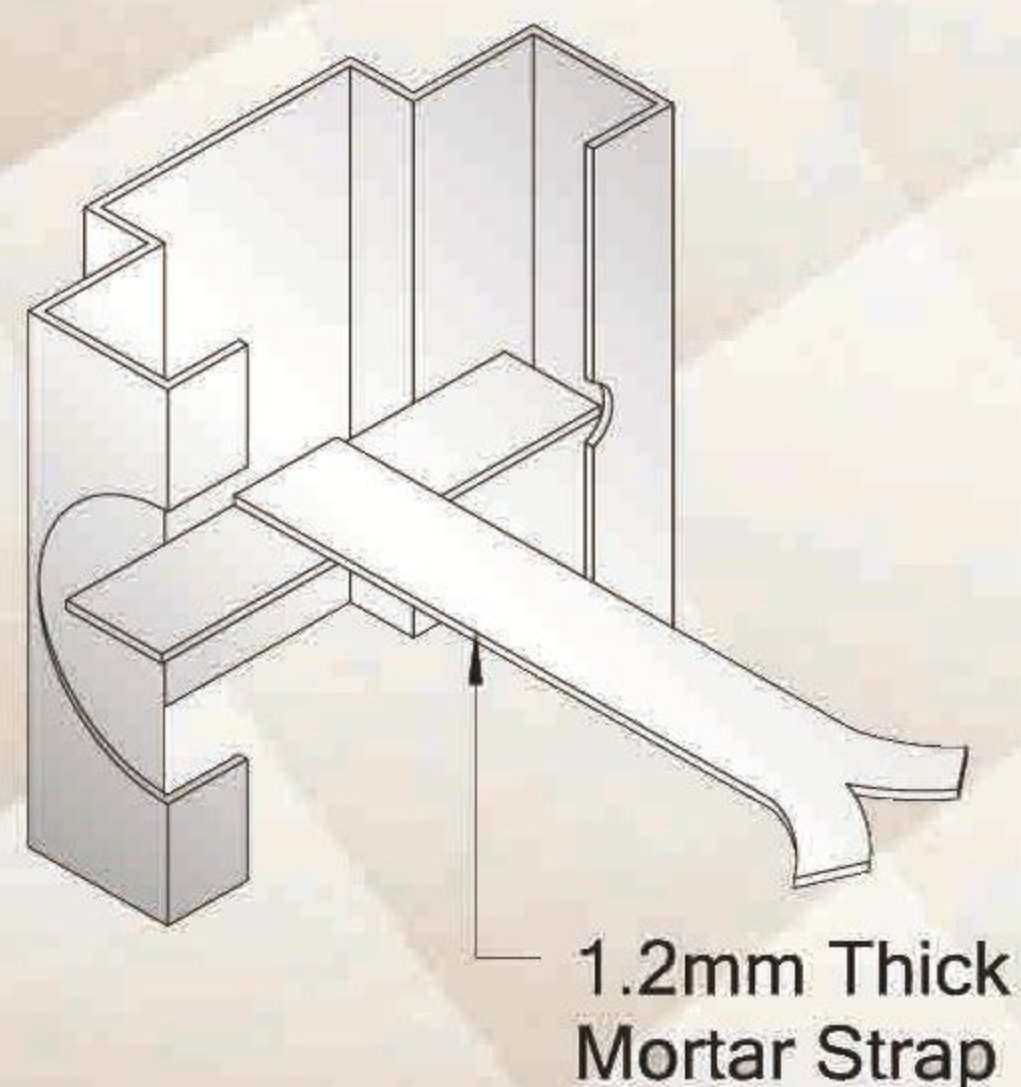

MORTAR STRAP

Weld or riveted

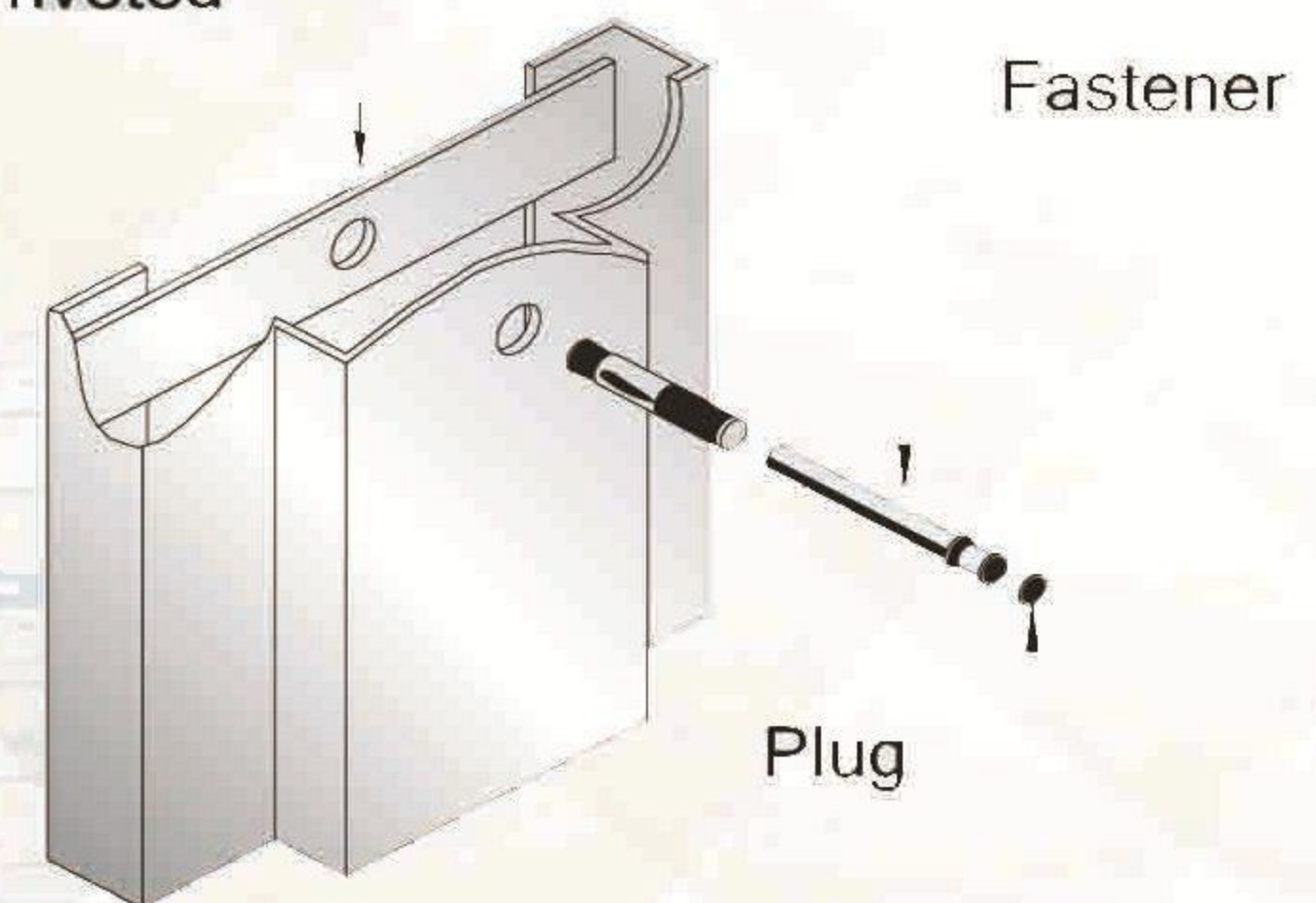

BOLT FIXING



## GAS OUTLET

Each gas-specific front part contains the following components :

- Actuator
- Cartridge
- Gas-specific socket unit
- Warning label (not ready for operation)

### CONSTRUCTION

Machined brass and zinc die-casting with stainless steel rolling pins

### SPECIFICATIONS

1. Medical GAs Outlet Oxygen Outlet
2. O<sub>2</sub>/Air/N<sub>2</sub>O/ Vacuum/CO<sub>2</sub>/N<sub>2</sub>/AGSS
3. Have past 100% gas tightness test
4. Materials : Copper

Gas type : O<sub>2</sub>, VAC, AIR, N<sub>2</sub>, N<sub>2</sub>O, CO<sub>2</sub>, AGSS and so on.

The body of material is Brass and sealing ring use medical silicone rubber.

Installation : Wall concealed installation ; medical bridge pendant installation;bed head unit installation and so on.

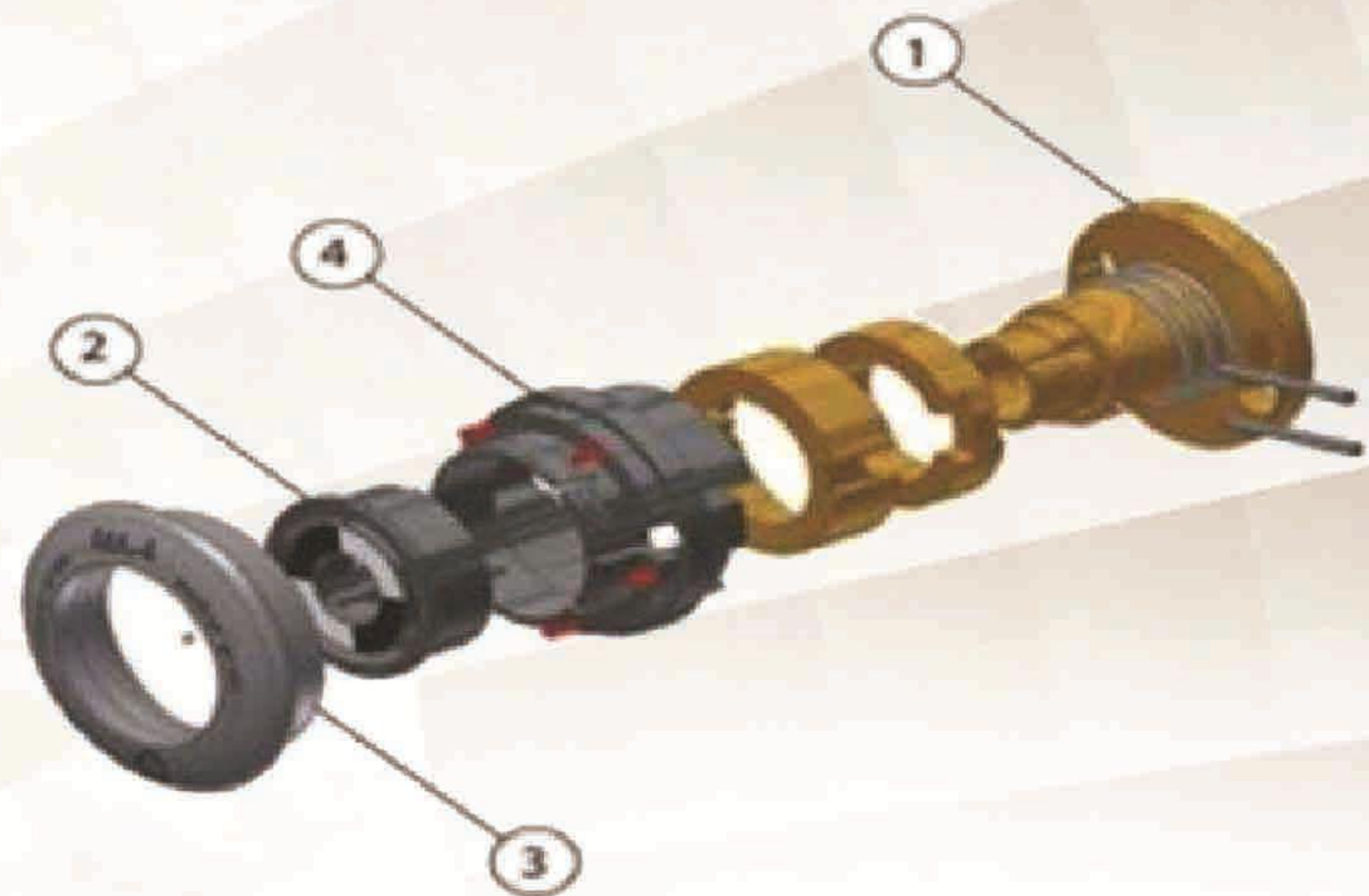
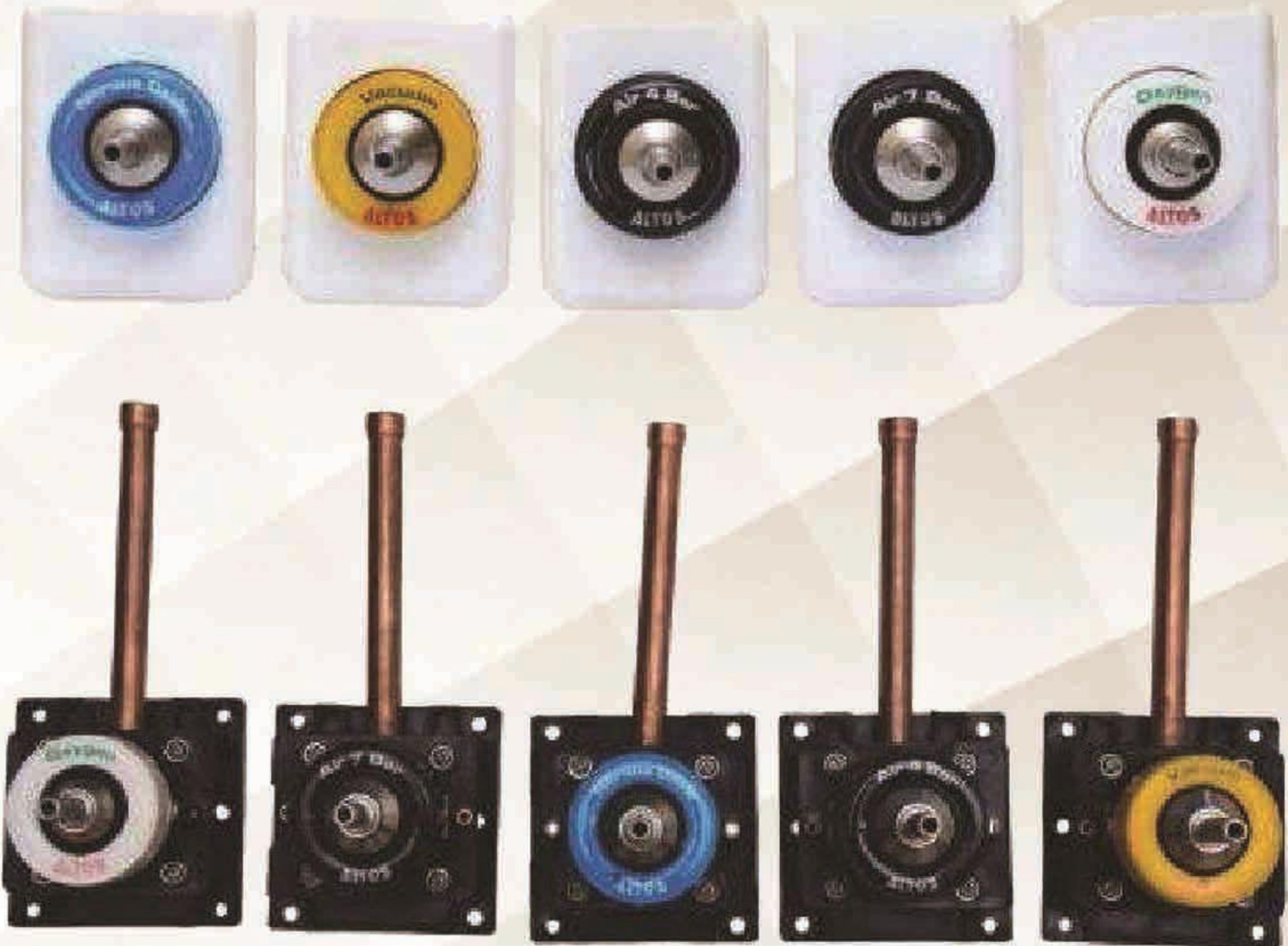

## GAS ALARM SYSTEM



**Analog Gas Alarm Systems**

Analog Gas Alarm Systems come in 1,2,3,4,5, and 6 gas categories where the number indicates the number of gases the system can handle. The system contains analog meters for displaying pressure of the different gases coming from the pipe lines. The system generates appropriate alarm in case of High pressure or Low Pressure in any gas. The alarm is shown on the Master Alarm System which is placed with the administration.



## HERMETICALLY SEALED SLIDING DOOR

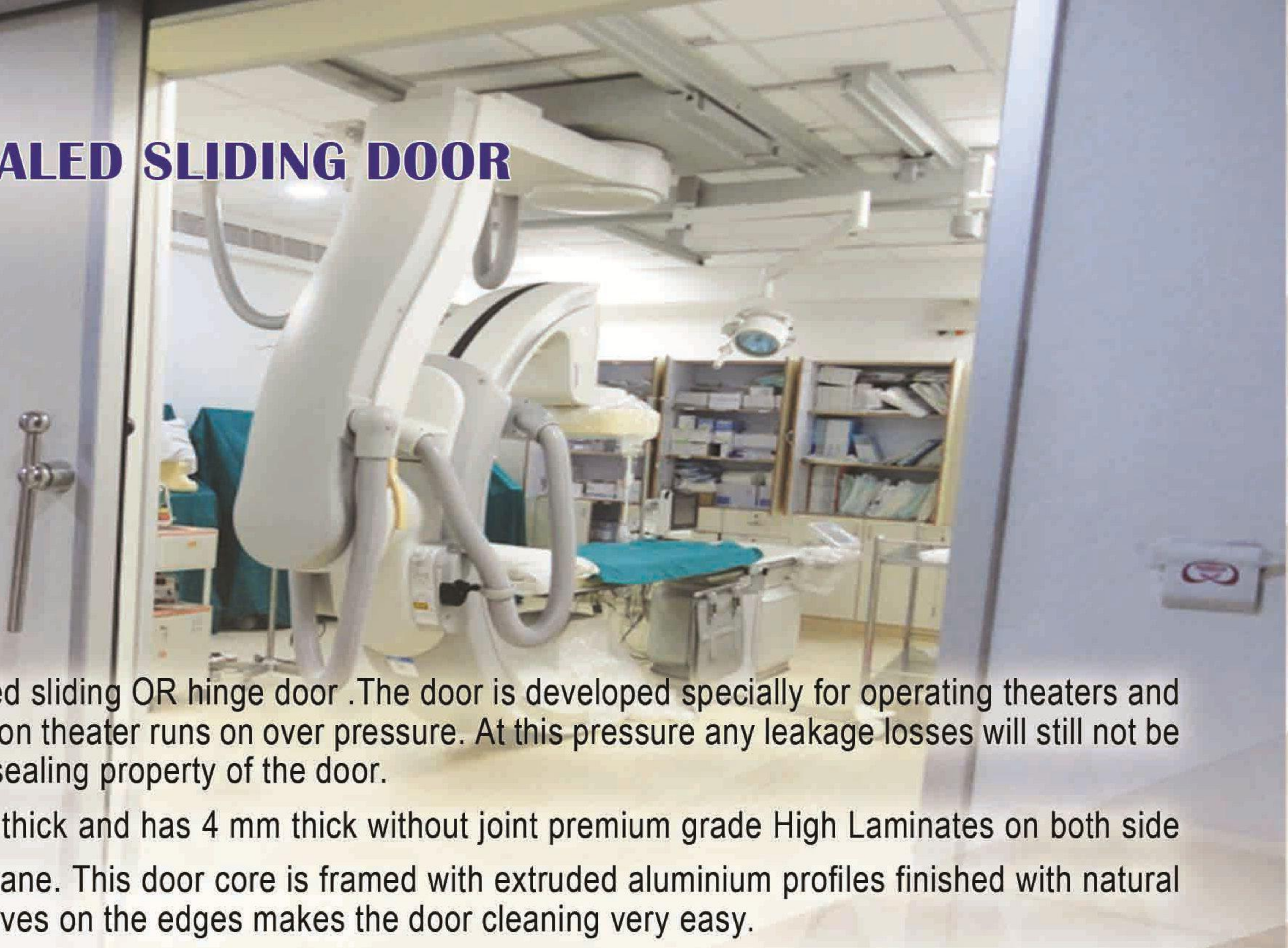

### SPECIFICATIONS

The BON2 is a hermetically sealed sliding OR hinge door. The door is developed specially for operating theaters and sterile areas. Normally an operation theater runs on over pressure. At this pressure any leakage losses will still not be measurable due to the hermetic sealing property of the door.

Core of the door blade is 60 mm thick and has 4 mm thick without joint premium grade High Laminates on both side of 52 mm thick injected polyurethane. This door core is framed with extruded aluminium profiles finished with natural anodizing. Smart radius and curves on the edges makes the door cleaning very easy.

Specially designed lever opener made out of solid stainless steel is there to ensure effortless opening and closing of the door. Automatic door is operated through CE marked European automation, specially designed for Rebbon hermetic sliding door.

The door blade comes with a border printed toughed glass sandwich vision window, flushed with both side core surfaces of the door.

Heavy duty track is provided as single length aluminium extruded profile, which allows the door to slide while opening and closing. The door goes down vertically towards the floor and in horizontally towards wall frame while closing simultaneously at an angle of 45 degree by using the weight of the door to make a perfect hermetic sealing. The door with hinge option, comes with European make fiber glass reinforced plastic made rising hinges and lever openers are provided with it.

High quality electroplated wheel chairs combined with self lubricating rollers fitted on double ball bearings ensure noiseless and friction free working for years after years.

Special Design of 3 tire EPDM sealing gasket to seal the aluminium wall frame and 2 tier bottom gasket fixed on the lower part of door blade to ensure perfect hermetic sealing with finished floor.

There are many option, which are available with this door i.e. Doors skin of 1.0mm thick S.S. 304 can be provided either/both side of door core, Door lock, Bigger size vision window, D-handle with flush grip for full passage opening, kick plate and S.S.304 guard columns etc.;





# VINYL FLOOR



## Different Shades :

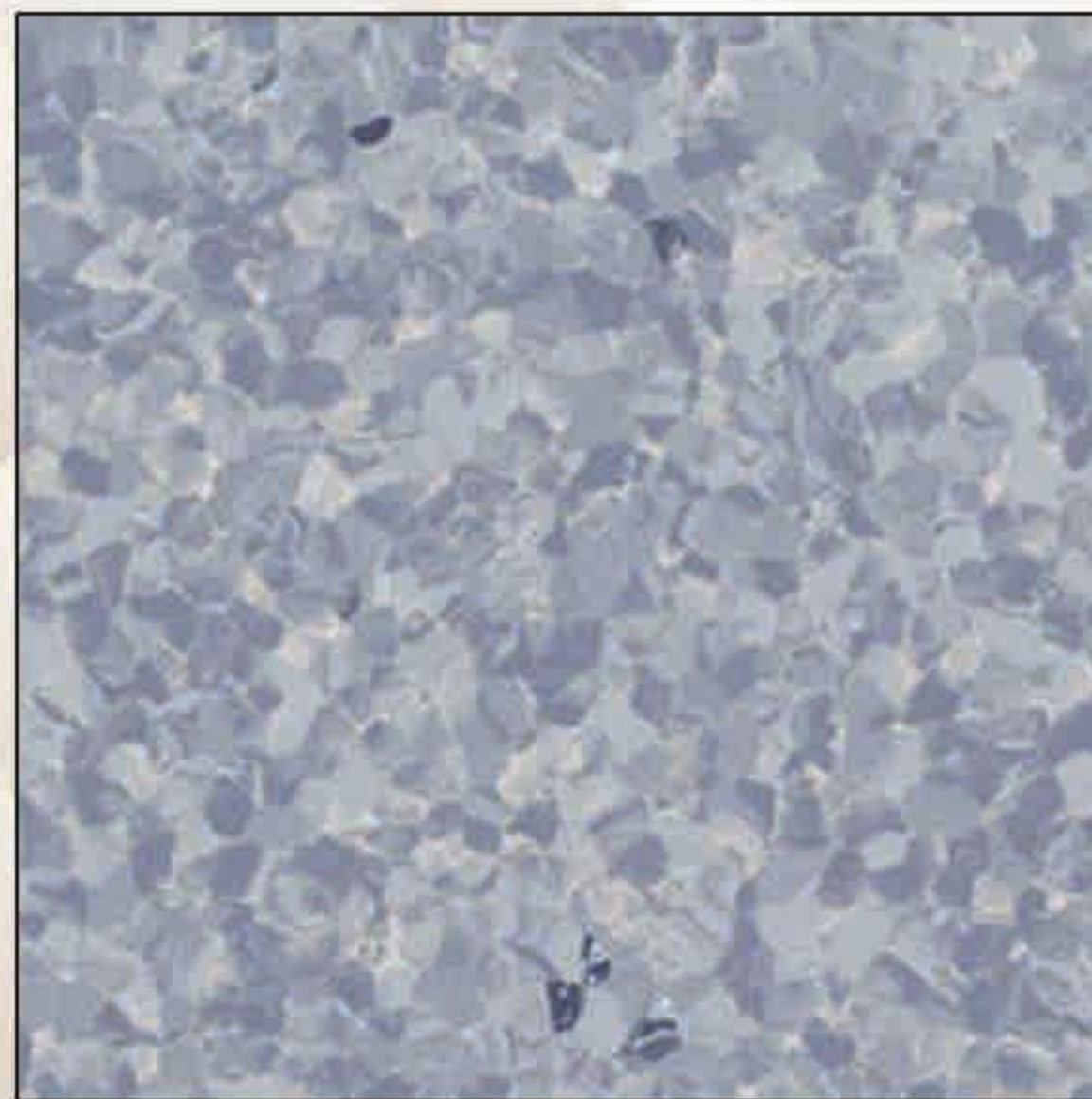
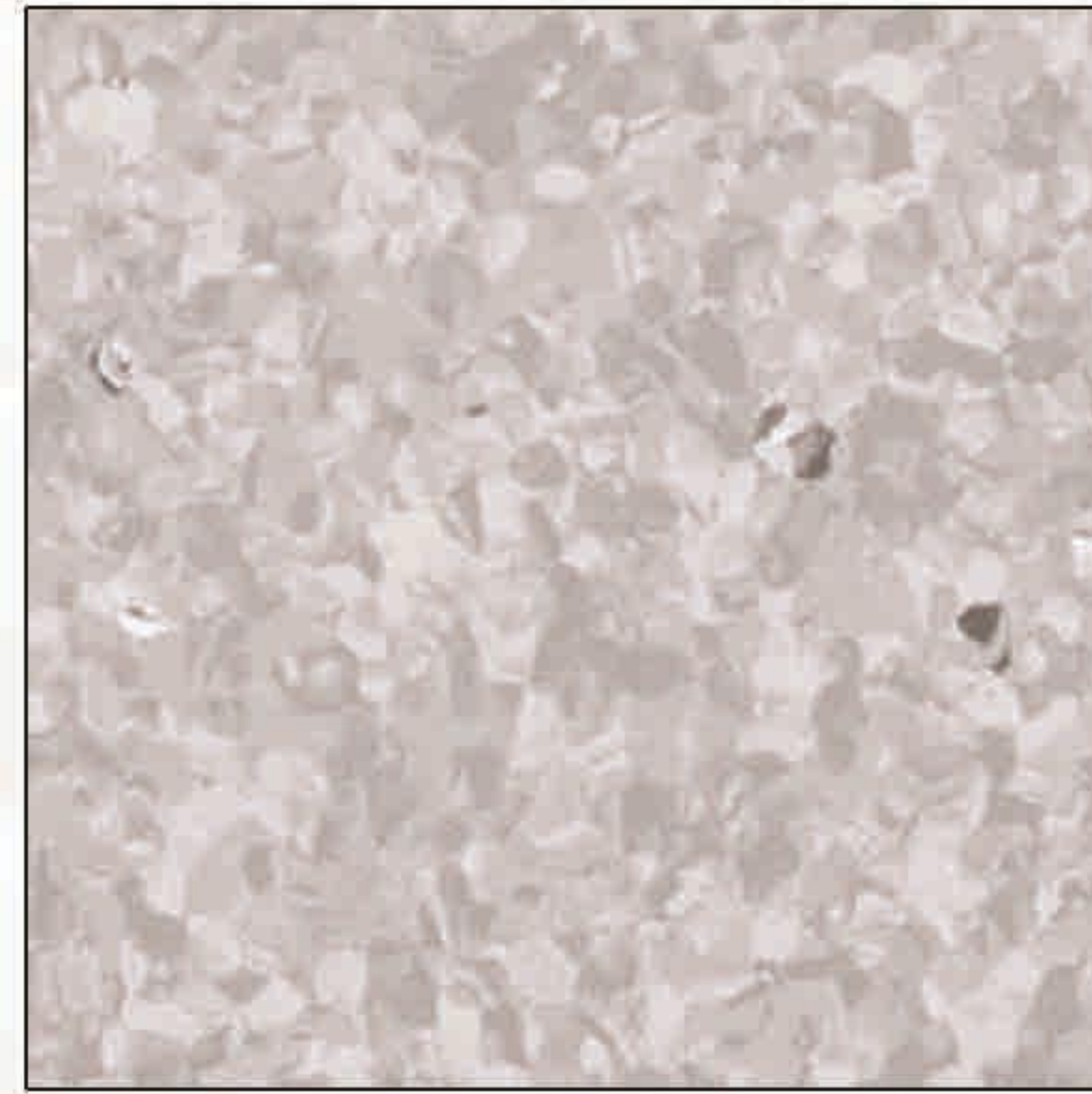



## SINGLE ARM SURGICAL PENDANT

### Technical Specification

Product Code	: SV 602
Product Name	: Single Arm Surgical pendant-Standard
Carriage Capacity	: Max 120 kg
Gas Equipment	: Variable according to project
Electrical Equipment	: 6 X Electric Sockets, (optional)
Operating Temperature	: (+10) - (+45)C <sup>o</sup>
Power Supply	: 220 V 50 Hz
Horizontal Arm Length	: 600mm to 1000mm
Packaging Type	: Wrapped Package / wooden packing with extra charge
Package Size	: 800 x 620 x 700 mm & 1070 x 140 x 260 mm & size of upper ceiling Mounting part
Product Weight	: 120Kg
Product Main Raw Material	: Aluminum Extrusion Profile & high impactive ABS with SS304 Screws
IV Stand	: Two Pole with Hangers
Colour	: Single/ Dual colour combination or as per requirement
Trays	: 2 (adjustable)

### Accessories

Gas outlets, Instrument basket, vacuum carrier, Monitor Stand/ Drawer/Trays



## DOUBLE ARM SURGICAL PENDANT



### Technical Specification

Product Code	: SV 603
Product Name	: Double Arm Surgical pendant
Carriage Capacity	: Max 100 kg
Gas Equipment	: Variable according to project
Electrical Equipment	: 6 X Electric Sockets, (optional)
Operating Temperature	: (+10) - (+45)C <sup>o</sup>
Power Supply	: 220 V 50 Hz
Horizontal Arm Length	: 2x600mm to 1000mm
Packaging Type	: Wrapped Package / wooden packing with extra charge
Product Weight	: 152Kg
Product Main Raw Material	: Aluminum Extrusion Profile & high impactive ABS with SS304 Screws
IV Stand	: Two Pole with Hangers
Colour	: Single/ Dual colour combination or as per requirement
Trays	: 2 (adjustable)

### Accessories

Gas outlets, Instrument basket, vacuum carrier, Monitor Stand/ Drawer/Trays



## GAS OUTLET

Each gas-specific front part contains the following components :

- Actuator
- Cartridge
- Gas-specific socket unit
- Warning label (not ready for operation)

### CONSTRUCTION

Machined brass and zinc die-casting with stainless steel rolling pins

### SPECIFICATIONS

1. Medical GAs Outlet Oxygen Outlet
2. O<sub>2</sub>/Air/N<sub>2</sub>O/ Vacuum/CO<sub>2</sub>/N<sub>2</sub>/AGSS
3. Have past 100% gas tightness test
4. Materials : Copper

Gas type : O<sub>2</sub>, VAC, AIR, N<sub>2</sub>, N<sub>2</sub>O, CO<sub>2</sub>, AGSS and so on.

The body of material is Brass and sealing ring use medical silicone rubber.

Installation : Wall concealed installation ; medical bridge pendant installation;bed head unit installation and so on.

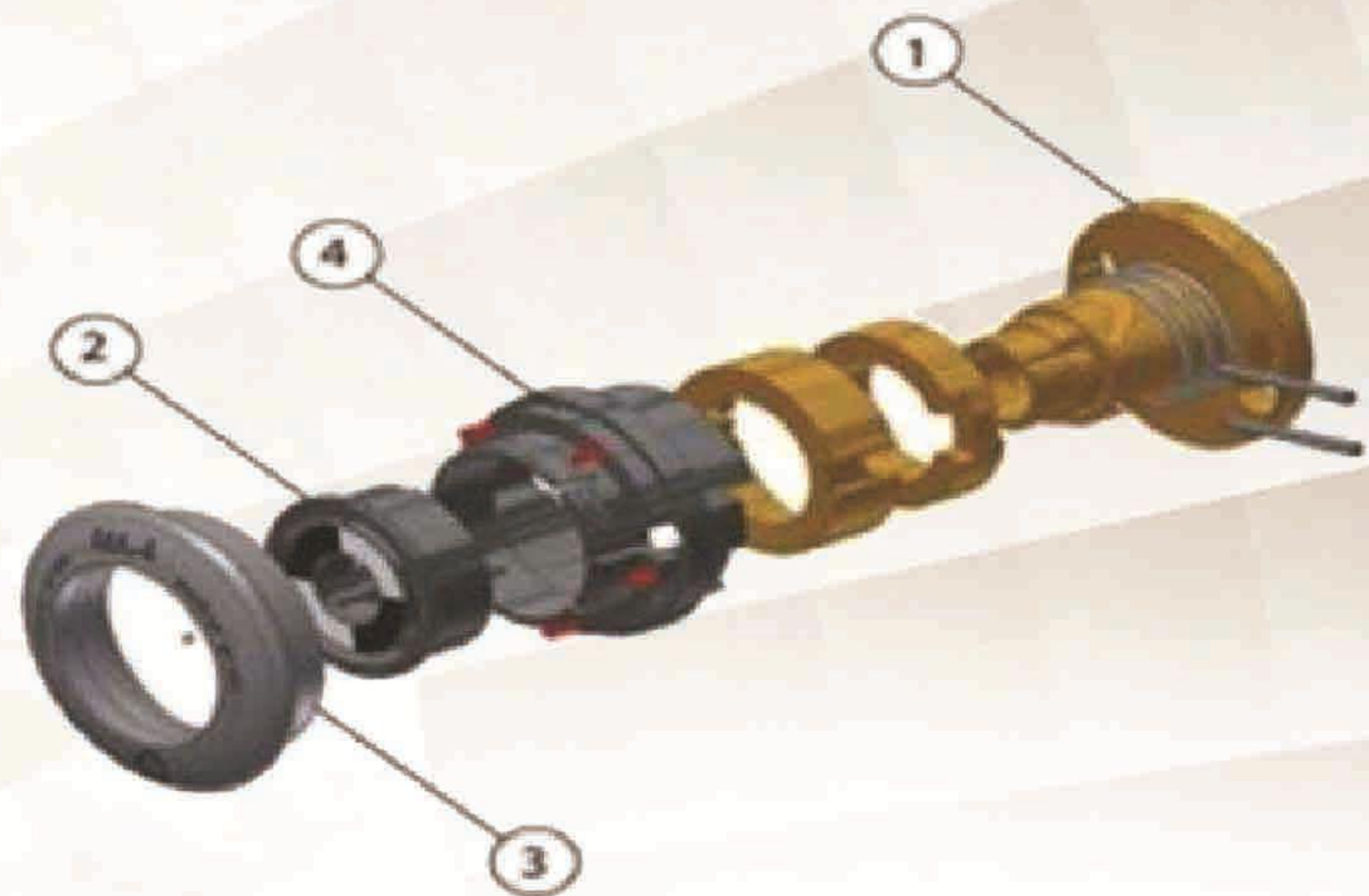
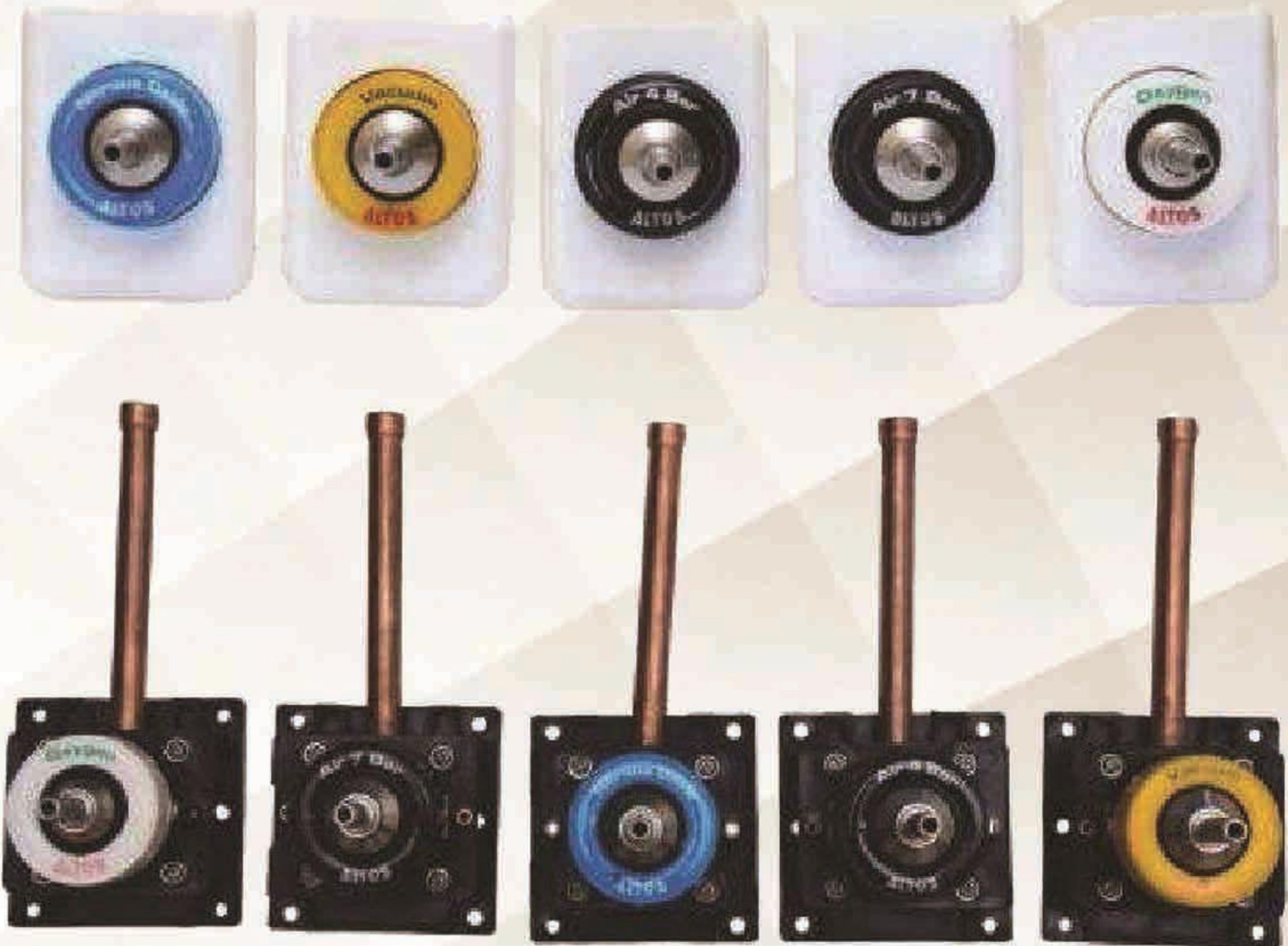

## GAS ALARM SYSTEM



**Analog Gas Alarm Systems**

Analog Gas Alarm Systems come in 1,2,3,4,5, and 6 gas categories where the number indicates the number of gases the system can handle. The system contains analog meters for displaying pressure of the different gases coming from the pipe lines. The system generates appropriate alarm in case of High pressure or Low Pressure in any gas. The alarm is shown on the Master Alarm System which is placed with the administration.





**SKYLIGHT PANEL**

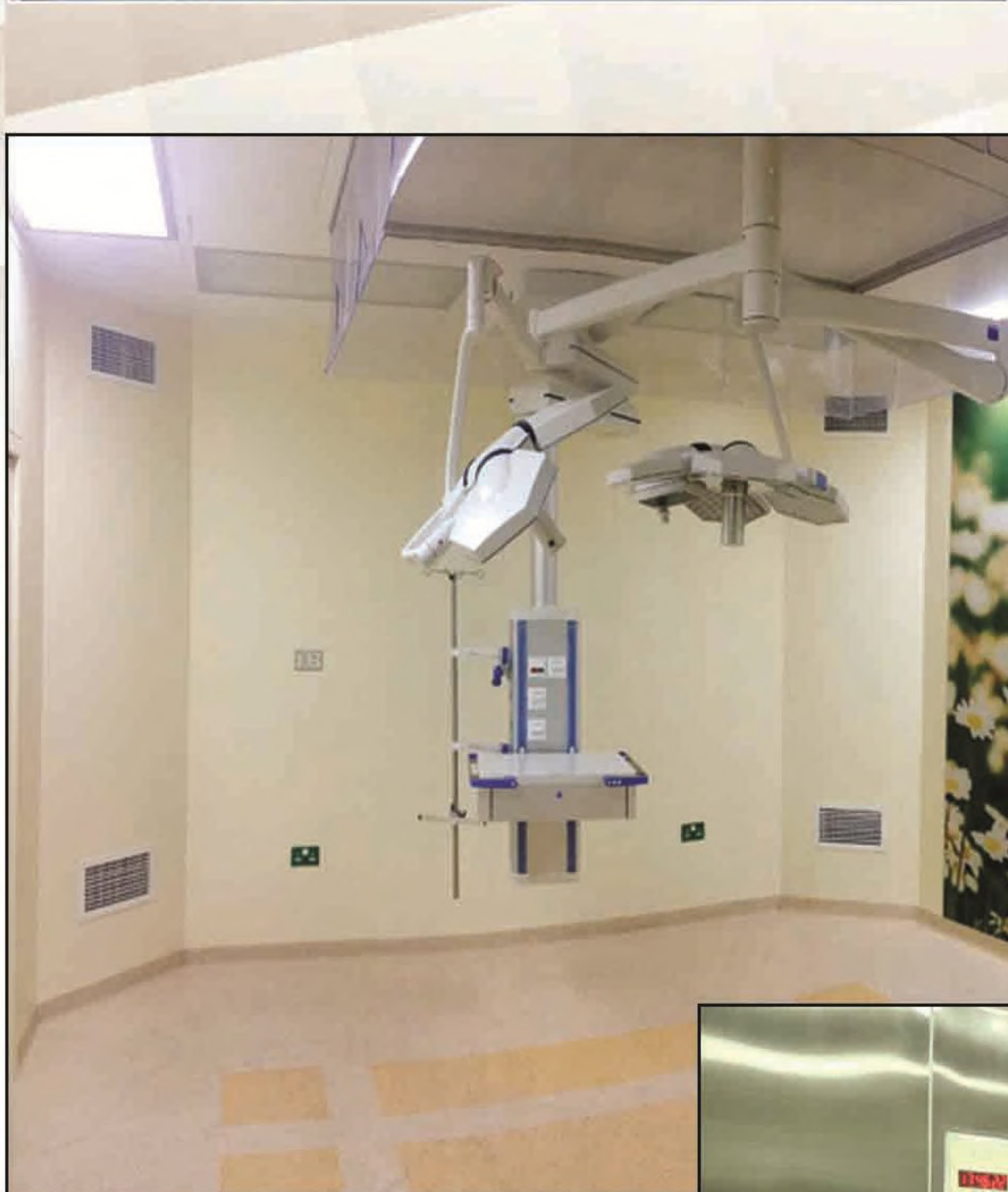

**GLASS PANEL**

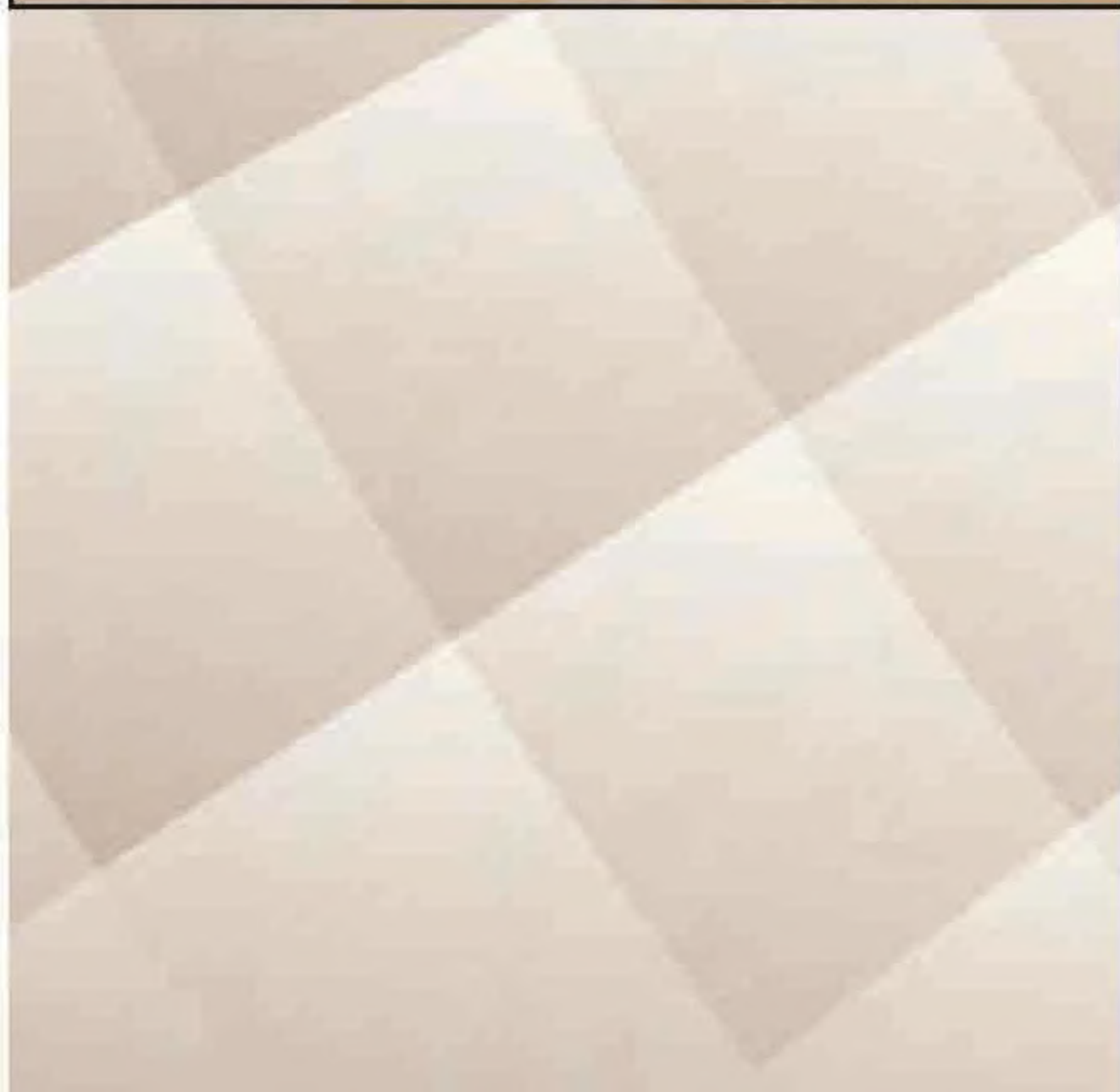



## BED HEAD PANEL

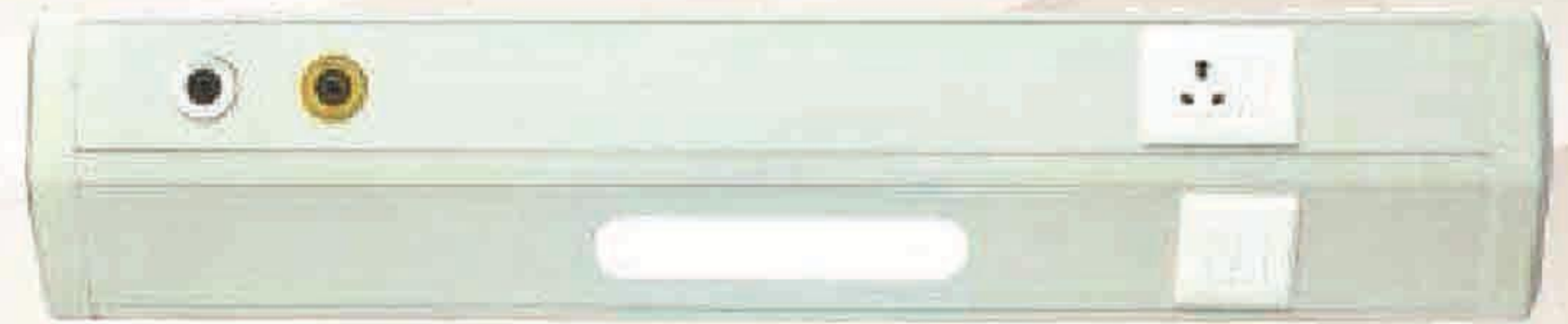

### SPECIFICATION :

1. Powder coated aluminum body
2. Electrical and wiring panels
3. Gas outlet front panels
4. UPS outlet
5. Power Outlet

## ZONAL VALVES & VALVE BOXES

### Valve Design

Valve Design Our fully ported brass valves features three-piece construction, double seals and quarter turn-to-off.

1. Able to 6 Valve
2. Each-each valve in special design according to standard medical gas
3. Easy maintenance and replacement
4. Standard UL, CSA, ISO and NEPA 99
5. Equipped nameplate of each gas

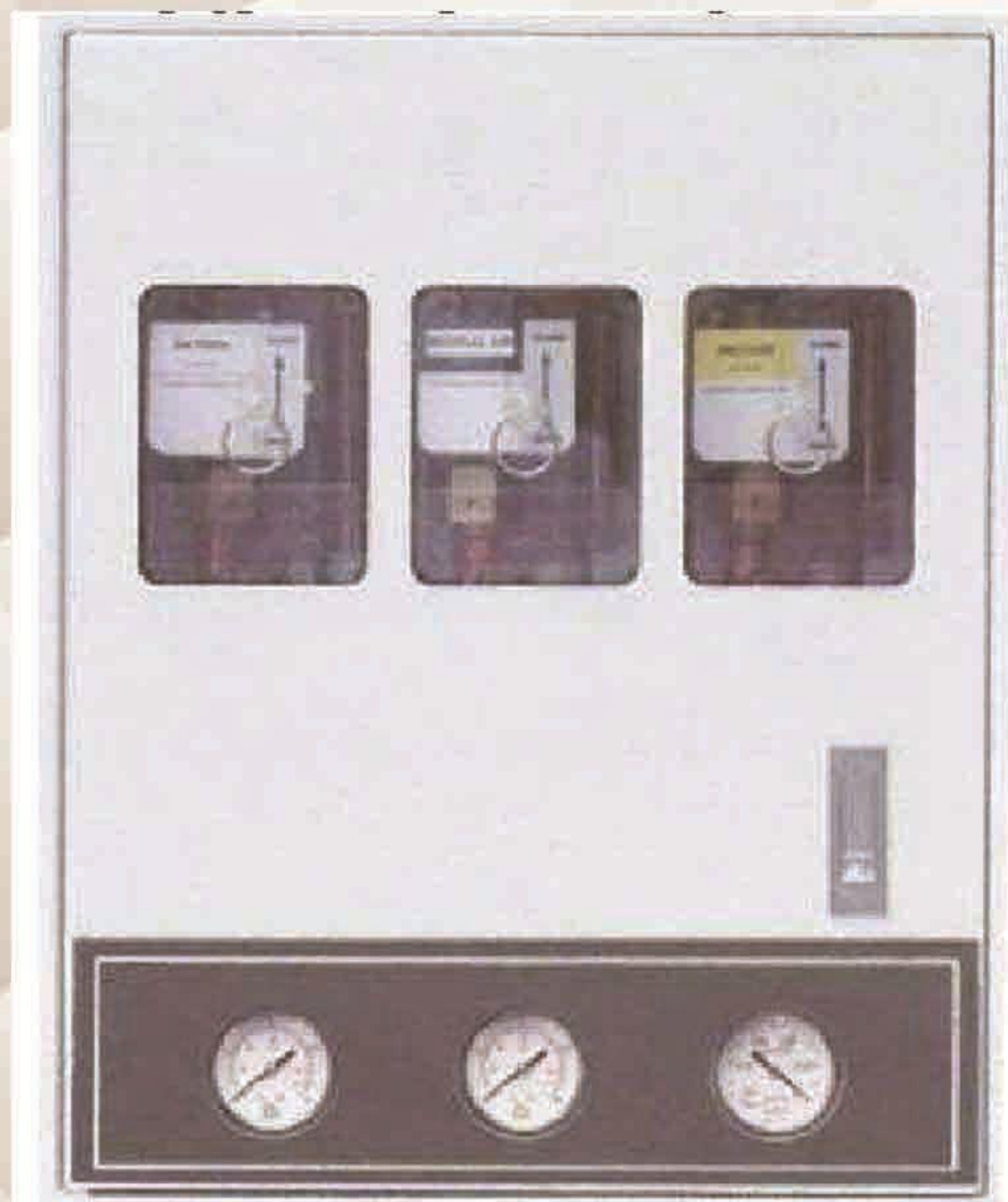

## PRESSURE CONTROL PANEL

Every Operating Room need at least one Nitrogen Control Panel. The Purpose of this panel is to regulate the Nitrogen Pressure from LINE (160-180) psi to what the user requires. Most pneumatic tools used in the OR, require 50-150 psi to operate.

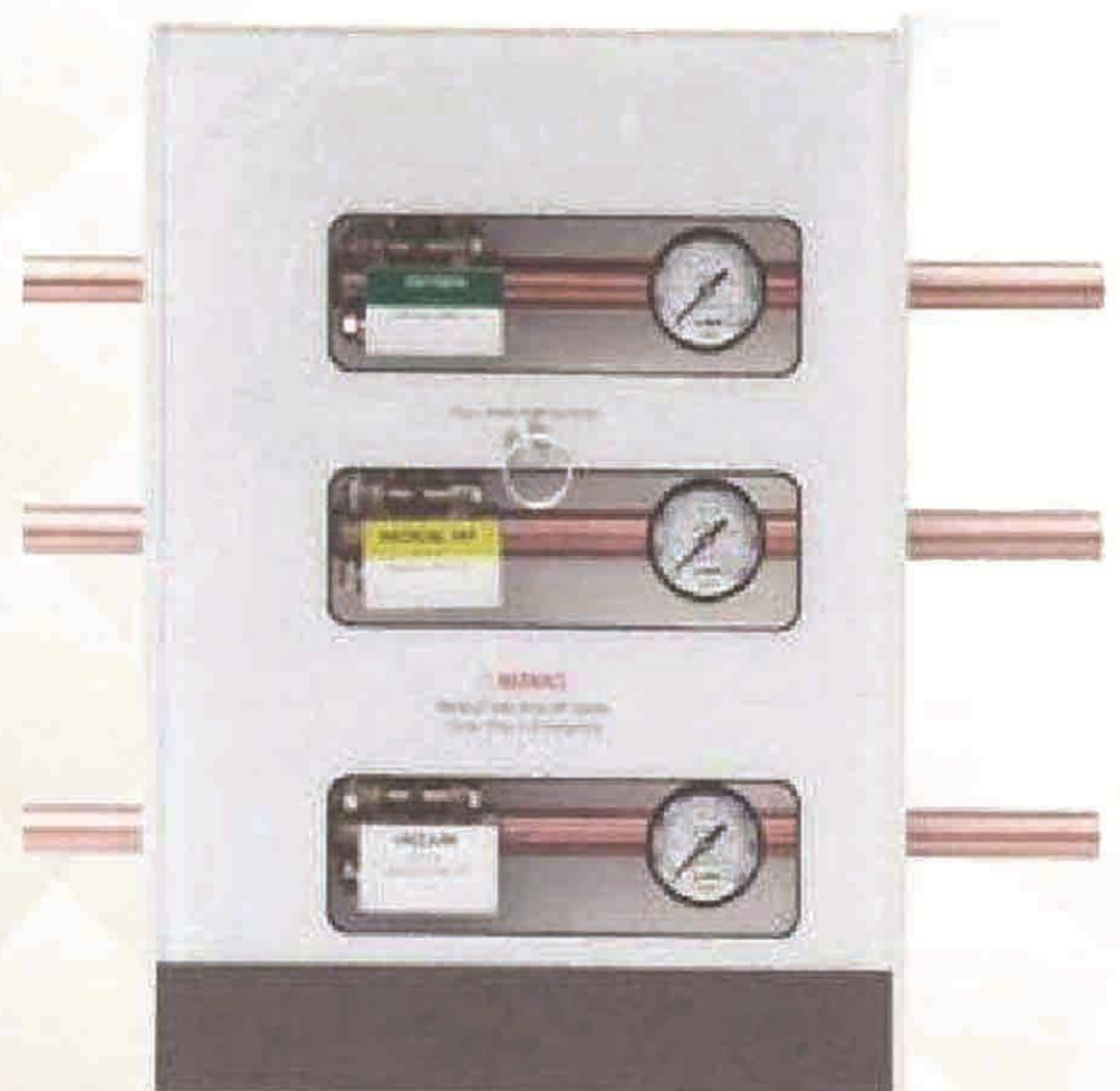



## SS SCRUB SINK



**DOUBLE BAY SCRUB STANDARD**

## AUTOMATIC SCRUB SINK



**SINGLE BAY SCRUB STANDARD**

## HATCH BOX (PASS BOX) STANDARD

Pass Boxes, are so designed to removed waste material from the operation theatre to dirty linen area/crower just adjacent to operation theatre

### Feature :

Product Code : SV-625 (S)

1. Automatic operated two doors
2. Material SS-304
3. One door can open at one time
4. Protected with UV light Off when any one door opens
6. Open /close states indicates on both side on display
7. Customize size
8. Microprocessor based controller

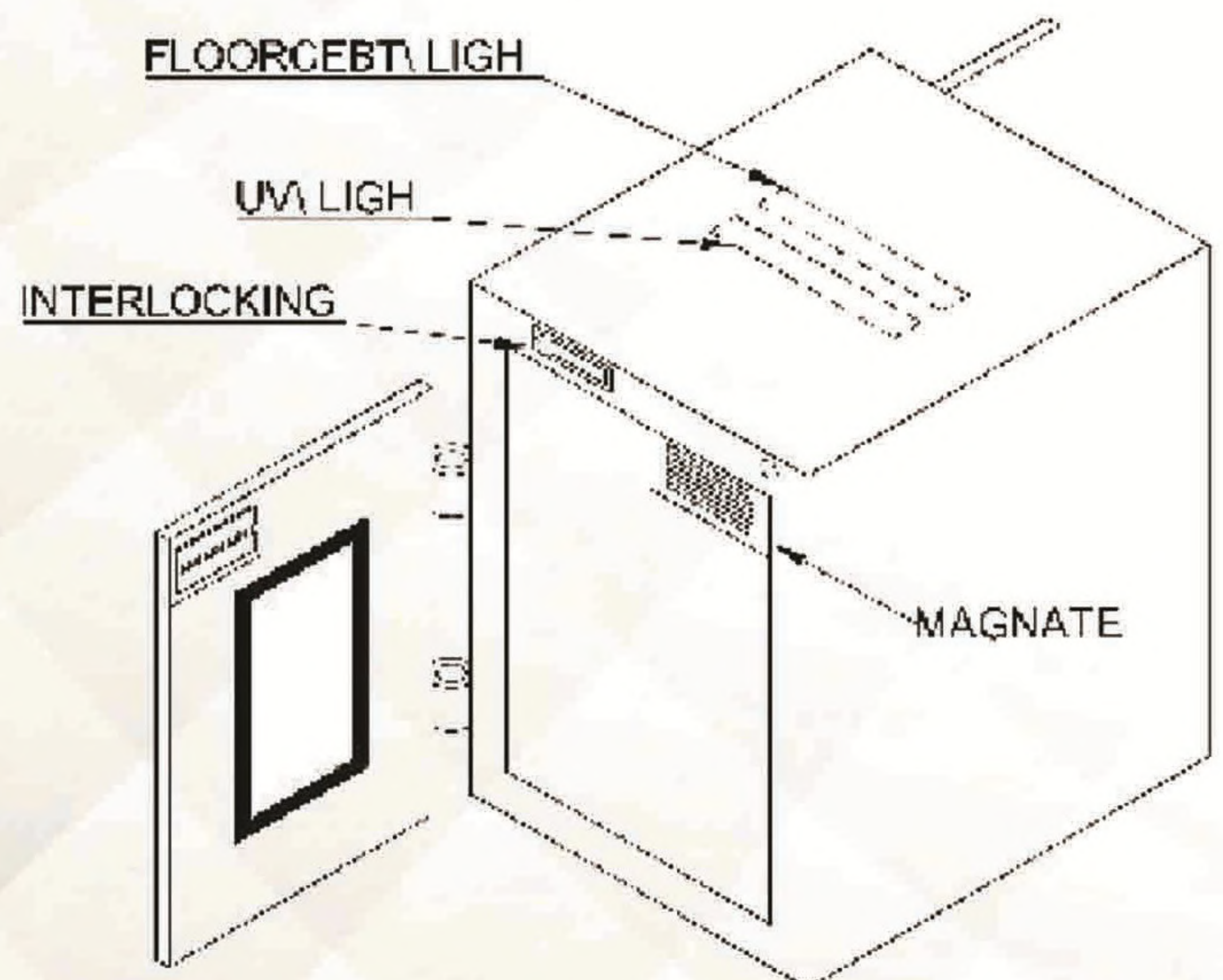





## X-RAY BOARD

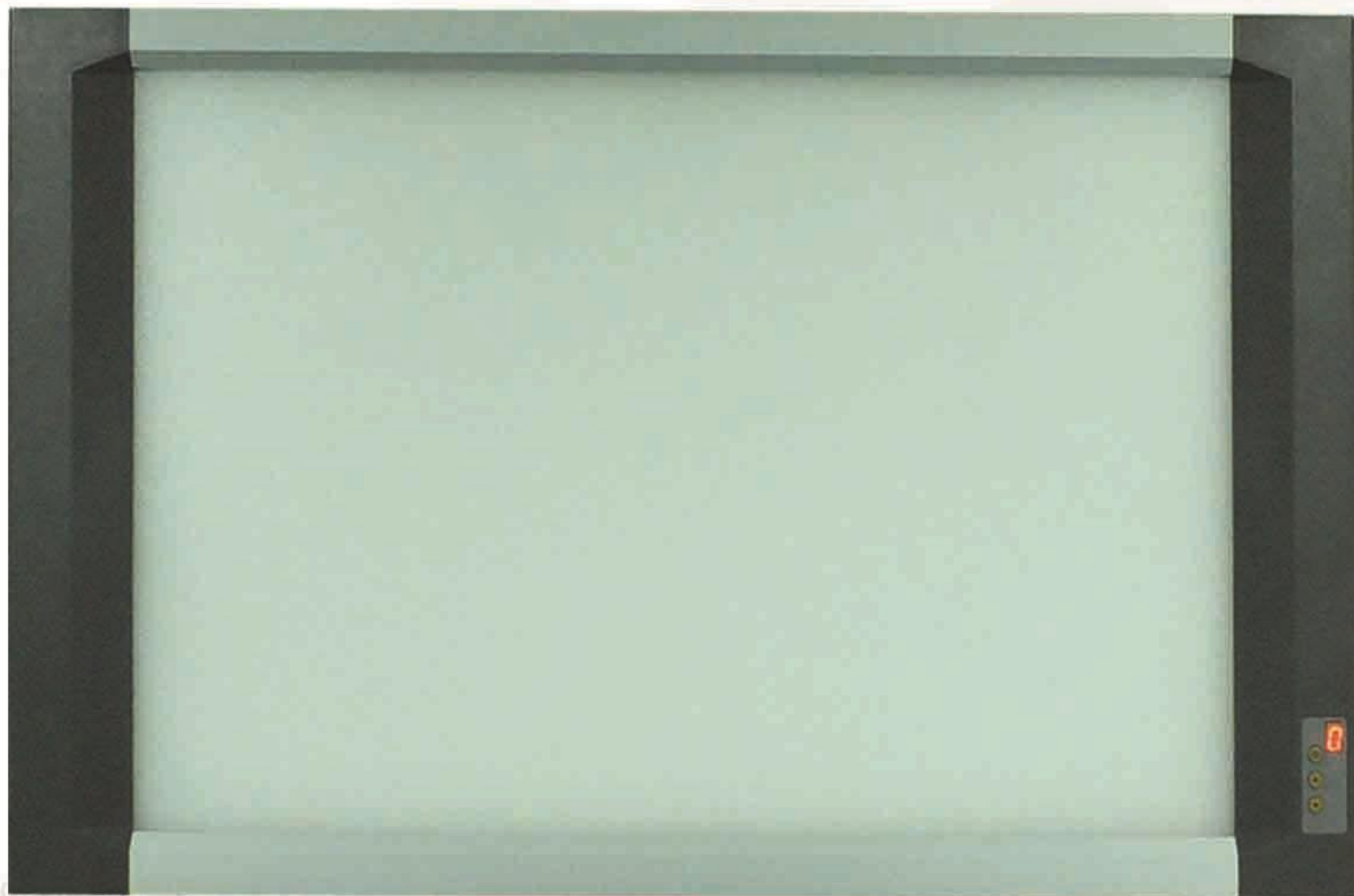

Specializes in the manufacture of X-ray film viewers (X-ray illuminator, X-Ray Film Viewer, LED X Ray Viewer, Slim LED View Box, X ray View Boxes, X Ray Viewer, View Box). Keeping the needs of the doctors in mind along with the continuously changing demands of hospitals and Nursing homes, we have developed a sleek and effective L.E.D. Viewing system to view M.R.I., C.T. and X Ray images . Bio-X offers a range of Single Screen, Double Screen, Triple Screen, Quadruple Screen viewers.

## PERIPHERAL LIGHT



Keeping the needs of our customer in mind along with the continuously changing demands of hospitals, hotels, commercial and residential projects we have developed an effective LED Ceiling Light.

## WRITING BOARD

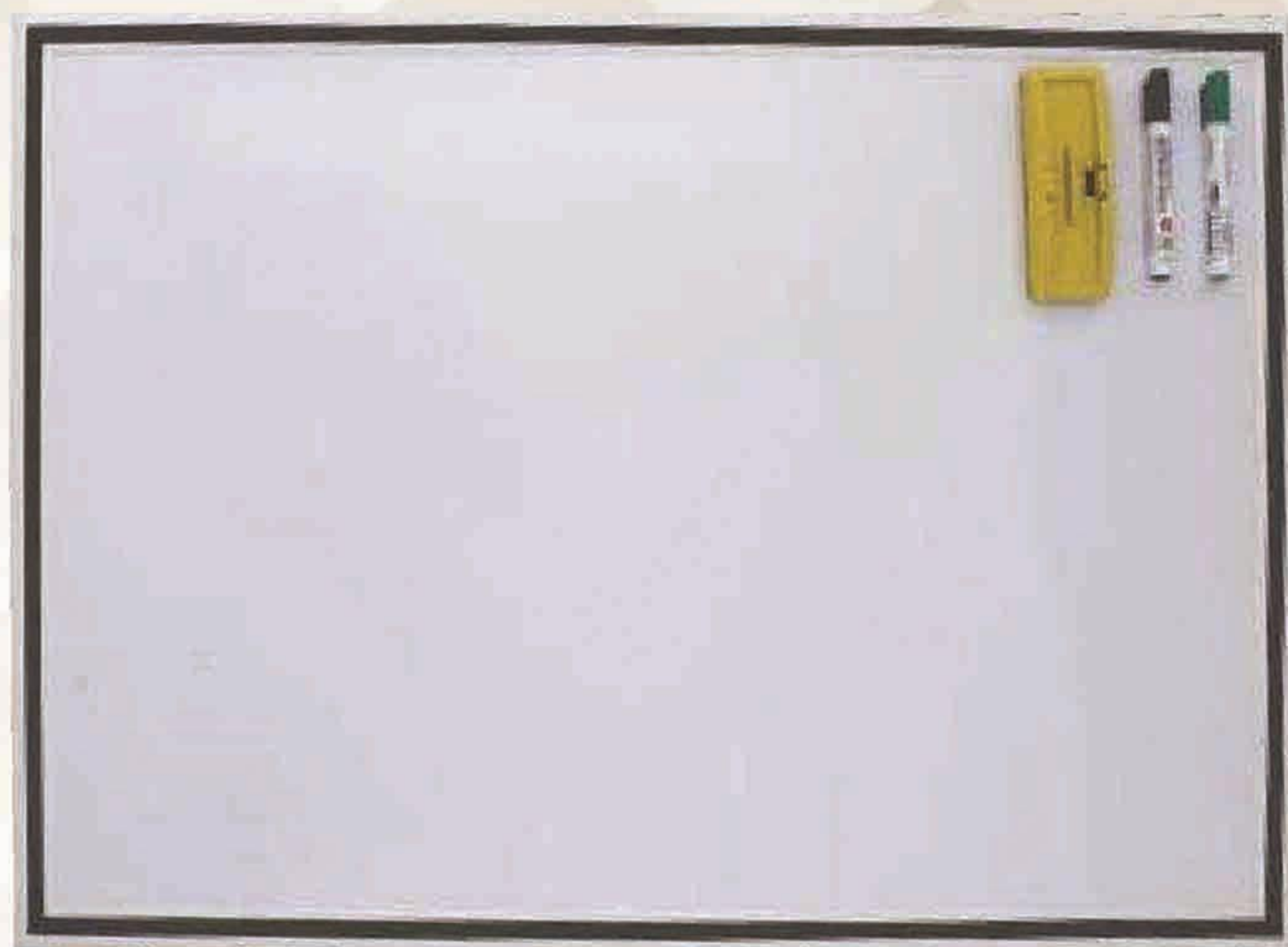

Owing to our extensive market experience, we are able to offer excellent quality.

## PRESSURE RELIEF DAMPER



Operating theatres need to be protected from the ingress of airborne contamination to maintain the air in a clean and sterile condition. Suitably sized air pressure relief damper strategically placed, enable differential room pressures to be maintained and ensure that when doors are opened between clean and dirty areas there is sufficient air flow through the open door to prevent cross contamination.



## CURTAIN TRACK & SYSTEM

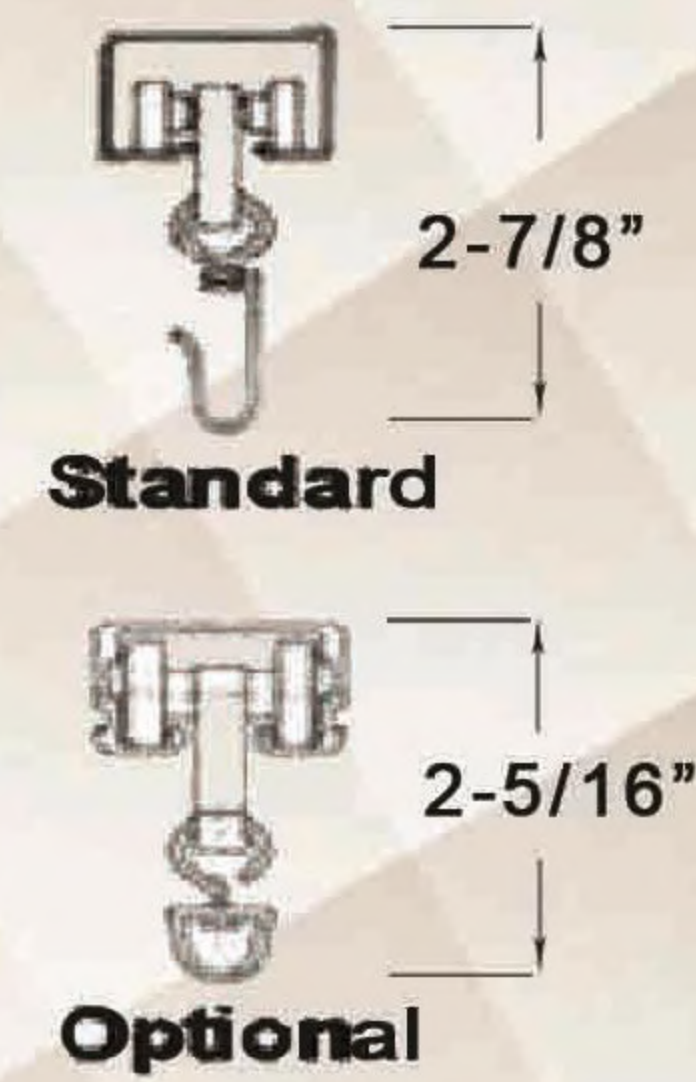

### Hospital Curtain Track System

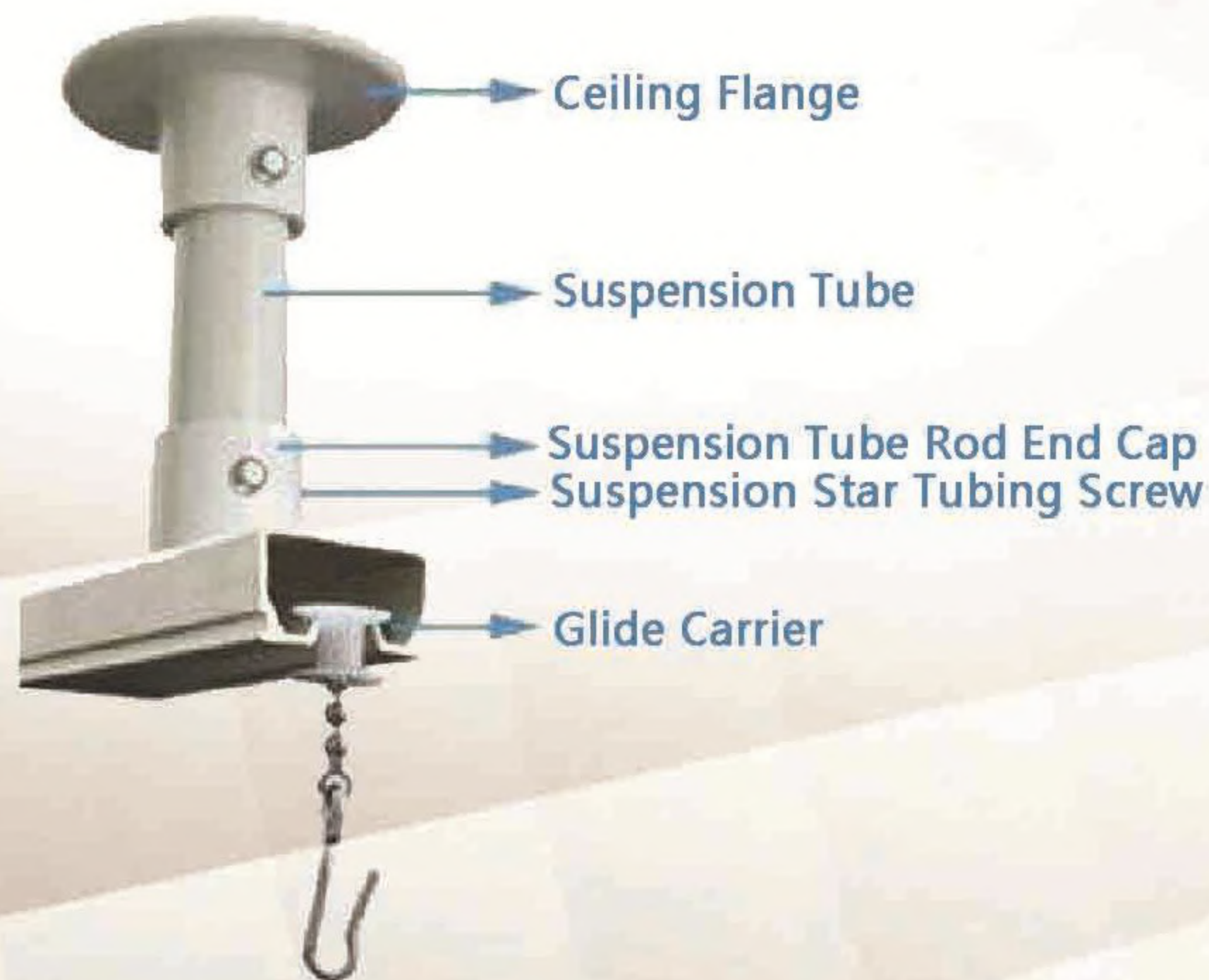

## NURSE CALL SYSTEM

It is designed with static windows and one can insert a bromide film (or similar thing) with the required letters to identify the room

Voice module with standard voice attention and patient calling instead of buzzer makes it distinguished.

Can replace legacy buzzer system without having to re-lay the wires

Very low working voltage to ensure patient's safety

Very simple design to make it easily installable and Maintenance free.

Door indicator helps the nurses to locate the calling patient easily.

Call from a patient remains registered till the nurse attends the patient and clears the call from his room







## S I Surgical Private Limited

SIS House, Nh6 Uttar Nibra, 2no Pump House,  
 Oppo. Mandirtala Sporting Club, Howrah : 711409,(W.B), India.  
 Phone No. : +91-033-2669-0085(4 Lines)  
 +91-9836296422

E-mail : info@sisurgical.co.in  
 sisurgicalcorp@gmail.com

Unit II : Subhas Enclave,Uttar Nibra(Near Kali Mandir),  
 Nibra,Howrah-711409,West Bengal

Unit III : 265, Roy Bahadur Road ,(Near Chhatra Sangha Club),  
 Kolkata-700053,West Bengal

## Other Branchs

Patna, Bhagalpur, Siliguri, Bhubaneswar, Guwahati, Hyderabad,  
 Chennai,Mumbai, Balashore,Coochin, Ahmedabad, Jodhpur,  
 Bhiwani, Nairobi, Dhaka,Columbo, Dar~es Salaam,Kathmandu,  
 Biratnagar, Hanoi etc.